



7 Egerton Gardens

Knightsbridge, London, SW3 2BP

£680 Per Week



2



1



1



D

Floor Plan

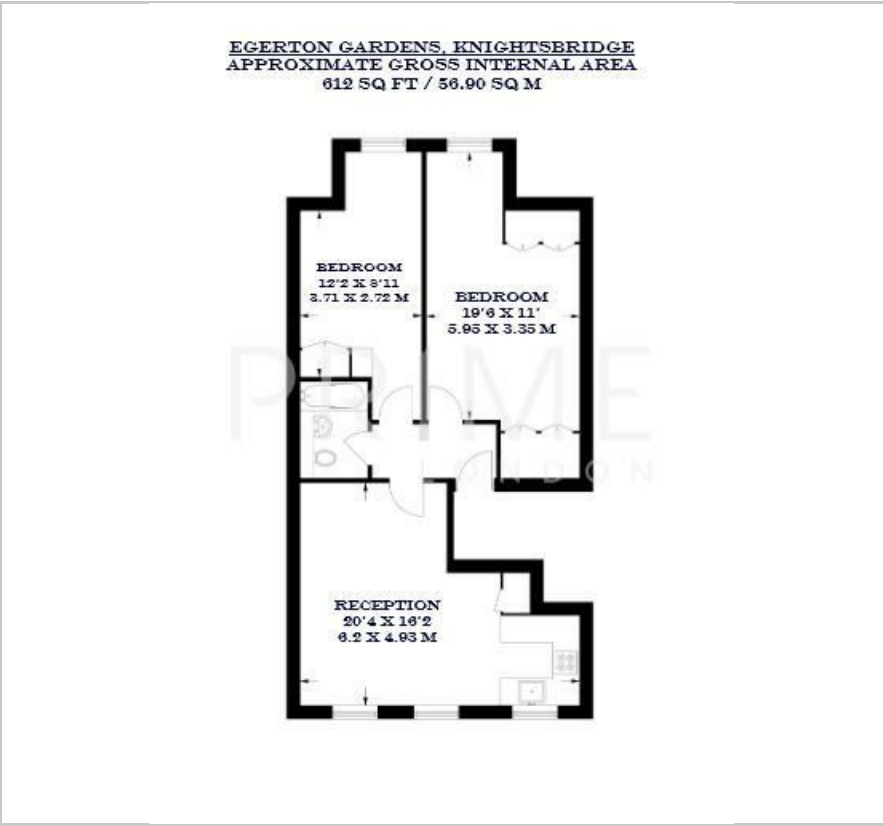

Area Map



Energy Efficiency Graph

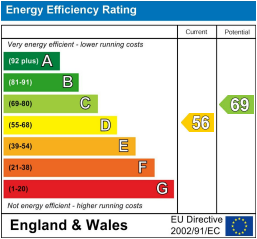

Viewing

By appointment. Contact us on 0207 052 1075 if you wish to arrange a viewing appointment for this property, or require further information.

- Two bedroom apartment
- 612 sq ft (56.90 sqm)
- Contemporary kitchen
- Ideally positioned between Knightsbridge and Chelsea
- Short stroll to Hyde Park
- Just 0.3 miles to South Kensington Station



This stunning two-bedroom apartment, set within a sought-after Knightsbridge address and offering stylishly designed interiors, is available for lease through Prime London.

Totalling 612 sq ft (56.90 sqm) of living space, including a spacious and bright open-plan reception room with a contemporary kitchen. The property also boasts two well-proportioned bedrooms, and one bathroom.

Egerton Gardens is a prestigious tree-lined street, ideally positioned between Chelsea and Knightsbridge. Residents enjoy proximity to the world-class boutiques of Brompton Cross, the vibrant atmosphere of King's Road, and an array of upmarket restaurants and cafés. The open green spaces of Hyde Park are just a short stroll away.

The property also benefits from excellent transport links, with Knightsbridge Underground Station (Piccadilly Line) and South Kensington Underground Station (Circle, District, and Piccadilly Lines) within walking distance.



These particulars, whilst believed to be accurate are set out as a general outline only for guidance and do not constitute any part of an offer or contract. Intending purchasers should not rely on them as statements of representation of fact, but must satisfy themselves by inspection or otherwise as to their accuracy. No person in this firm's employment has the authority to make or give any representation or warranty in respect of the property.